

# Beautiful, affordable custom kitchens **delivered on time, every time.**

## SOFT CLOSE DRAWERS & DOORS: PEACE IN THE KITCHEN.

Imagine this in your home: cabinet drawers that extend fully and close quietly, and cabinet doors that close quietly. Miseno Custom Cabinetry drawers are standard with full extension for easy access, no glide hardware showing, and a whisper quiet close that steers even fully loaded drawers to a smooth, silent closure. Soft close doors are standard on all overlay cabinetry, and on inset cabinetry built with concealed hinges.

### ALL-WOOD CONSTRUCTION, INSIDE AND OUT

- We use all-wood construction to make Miseno Custom Cabinetry. There is no cheap wood or fake wood in our cabinetry.
- Our cabinets have substantial end panels—they can handle your granite countertops! Our end panels are made from hardwood plywood that is 3/4" thick.
- We create drawers with 3/4" thick hardwood and dovetail joinery.
- Because the glides are underneath, drawers can be as wide as possible, giving you more room and more organizational options.
- Shelves are 3/4" thick hardwood plywood. The shelves are adjustable, so you can arrange your cabinet how you want.
- The interiors are bright, light and easy to keep clean.

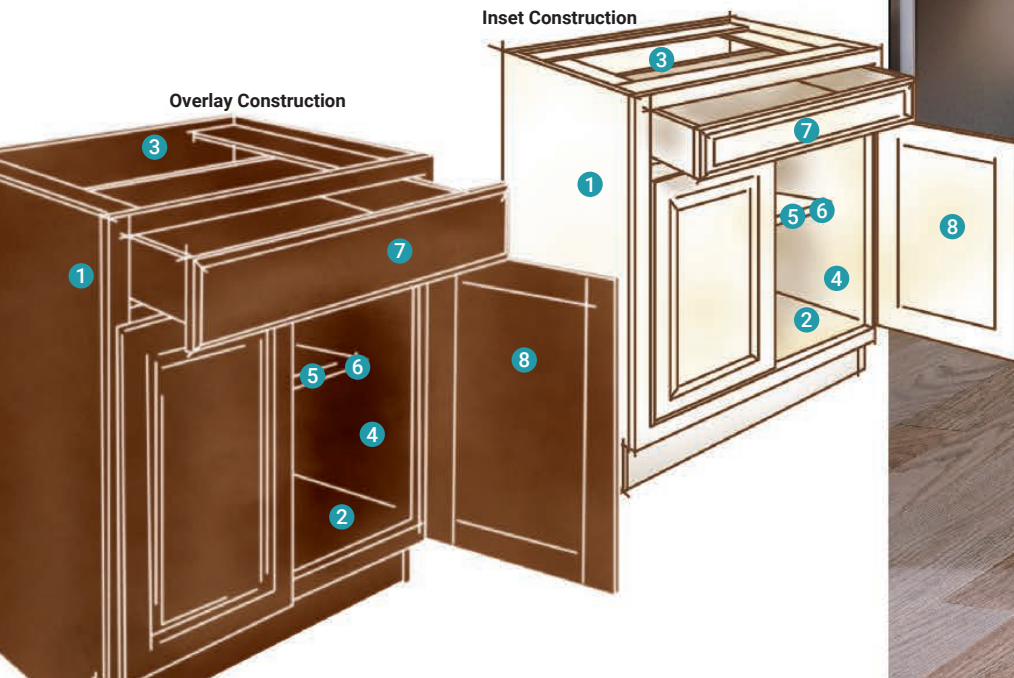

## MISENO —CUSTOM CABINETRY—

		Overlay Construction	Inset Construction
1.	End (side) Panels <i>Several options, including</i>	3/4" hardwood plywood veneer core-unfinished <i>Finished, Flush, Furniture, Beaded, Decorator</i>	3/4" hardwood plywood veneer core-unfinished <i>Finished, Flush, Beaded, Furniture</i>
2.	Tops & Bottoms	1/2" hardwood plywood veneer core	1/2" hardwood plywood veneer core
3.	Back Panels <i>option</i> <i>option</i>	1/4" hardwood plywood 3/8" beaded back 3/4" flush back	1/2" hardwood plywood 3/8" beaded back 3/4" flush back
4.	Interiors <i>option</i>	Natural birch melamine <i>Stained matching veneer</i>	Natural birch melamine <i>Stained matching veneer</i> <i>Natural maple veneer</i>
5.	Shelves	3/4" hardwood plywood	3/4" hardwood plywood
6.	Base Cabinet Shelves <i>option</i>	Two thirds deep <i>Full depth</i>	Two thirds deep <i>Full depth</i>
7.	Drawers & Rolls Trays <i>Glides</i>	Nominal 3/4" hardwood birch, dovetail joinery Soft close, full extension, undermount, 100 lb. capacity	Nominal 3/4" hardwood birch, dovetail joinery Soft close, full extension, undermount, 100 lb. capacity
8.	Door hinges	Adjustable soft close hinges	Finial hinges in five colors or concealed hinges with soft close mechanism

## INVEST WITH CONFIDENCE

Miseno Custom Cabinetry's construction, materials and finishes are covered by a limited Lifetime Warranty.



## OVER 900,000 COMBINATIONS PLUS CUSTOM COLORS

You'll find exactly what you want from our wide selection of door styles and colors. Wood types include Alder, Cherry, Hickory, Lyptus, Maple, Red Oak, Quarter Sawn Red Oak, Rustic Alder, Rustic Cherry and Rustic Hickory. We also offer custom colors and custom distressing. For more information, browse the **Colors, Styles & Accents** brochure.

## A PLACE FOR EVERYTHING

Choose from hundreds of organizational accessories. For more information, browse the **Organize & Store** brochure.



# MISENO

— CUSTOM CABINETRY —

## STRONG AT THE FINISH

All cabinet manufacturers have access to the industry's entire line up of finish materials, from good to better to best. At Miseno Custom Cabinetry, we start with the best material.

Then, we choose processes that make the most of these finish materials. Most of these processes involve elbow grease! No cabinet manufacturer puts more manual labor and handwork into each cabinet than Miseno Custom Cabinetry.

Each finish we offer creates a unique furniture look, adding beauty, color, and depth to nature's most versatile material: wood.



Miseno Custom Cabinetry is **CARB II COMPLIANT**. In technical terms, this means 100% of Miseno Custom Cabinetry's products are compliant with the California Air Resources Board (CARB) Airborne Toxic Control Measure (ATCM) to reduce formaldehyde emissions from composite wood products including hardwood plywood (HWPW), medium density fiberboard (MDF), and particleboard (PB) (Title 17, California Code of Regulations §93120-93120.12).

In laymen's terms, it means that Miseno Custom Cabinetry complies with the nation's strictest regulations regarding formaldehyde.

Miseno Custom Cabinetry is also **ESP CERTIFIED** by the KCMA (Kitchen Cabinet Manufacturers Association). ESP (Environmental Stewardship Program) certification is awarded to manufacturers who use materials with low formaldehyde emissions, use recycled materials, and use hardwoods certified through a recognized sustainable forestry program. Certification must be earned yearly.

Miseno Custom Cabinetry's CARB II COMPLIANCE coupled with our ESP certification, assures that your cabinetry is manufactured by an environmentally responsible company with environmentally friendly manufacturing materials and processes.



Kitchen Cabinet Manufacturers Association Environmental Stewardship Program

All products impact the environment.

For ESP program criteria, visit [kcma.org](http://kcma.org).